

PROSPECTOR SHOWCASE

MAY 11 & 25, 2021



KAMLOOPS
EXPLORATION GROUP

Sponsored in part by:



FOUNDEX
EXPLORATIONS LTD.

Presenter Bio



Prospector: John La Rue

Project: Dancer / Chalice Gold Silver Project

Brief Introduction:

- More than \$1million past exploration expenditures with > \$75,000 spent within past 3 years
- > 30 significant gold-silver showings associated with >3 km of correlative geophysical anomalies
- Permitted for 1000 meters of diamond drilling and extraction of a 10,000 tonne Bulk Sample from the JR Zone
- Potential to develop a cash flow from our permitted exploration program

Project Location

Dancer Chalice Project

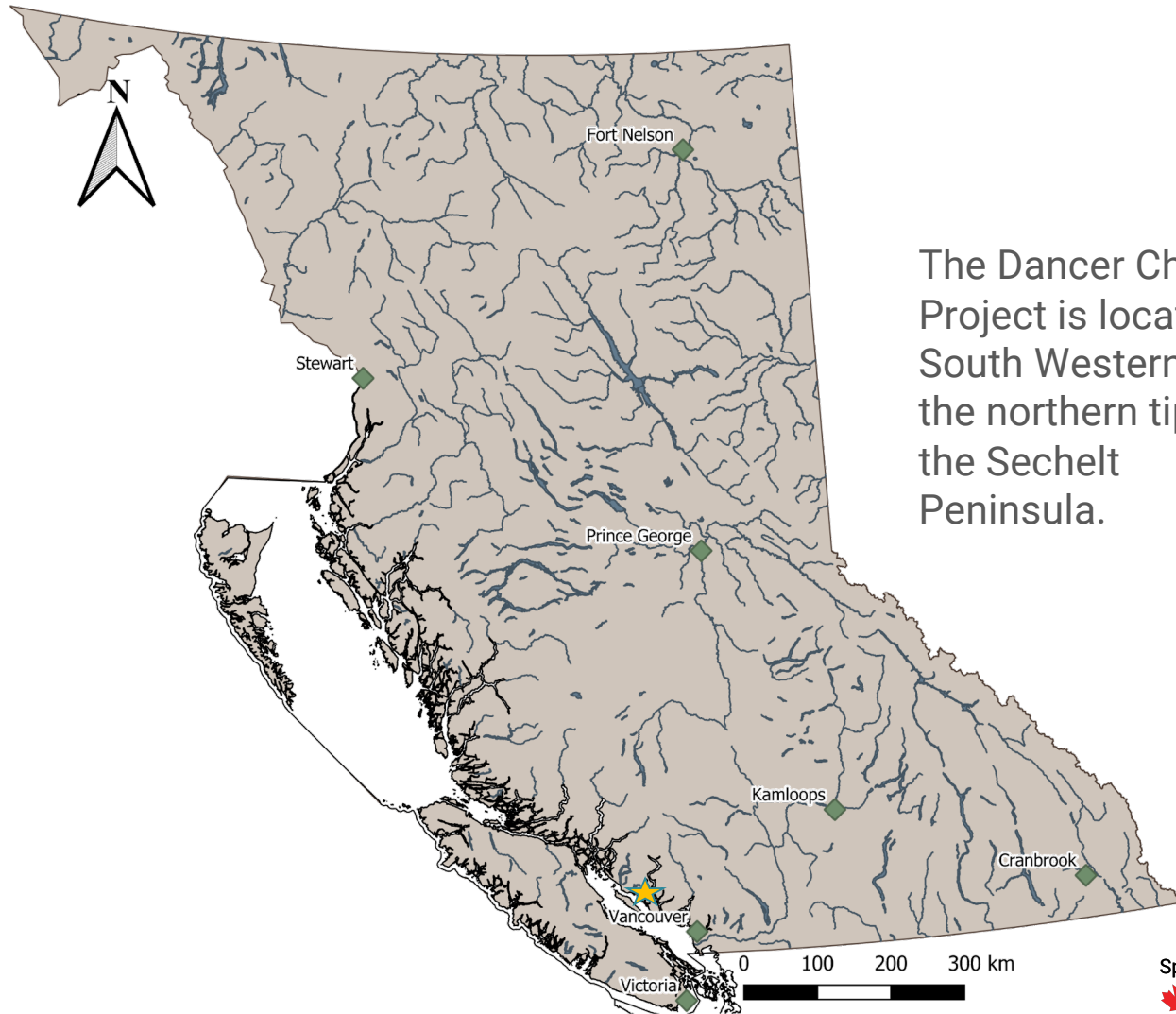

The Dancer Chalice Project is located in South Western BC at the northern tip of the Sechelt Peninsula.

Prospector: John LaRue - AMA Gold Exploration Ltd.
Property Location: Egmont



Project Location

Dancer Chalice Gold-Silver Project



The Dancer Chalice Project is located within 150 km of Vancouver, BC an approximate three hour drive from Vancouver via ferry and highway travel.

Prospector: John LaRue - AMA Gold Exploration Ltd.
Property Location: Egmont

KAMLOOPS
EXPLORATION
GROUP
PROSPECTOR SHOWCASE

Sponsored in part by:
FOUNDEX
EXPLORATIONS LTD.

Claim Details



The Dancer/Chalice Property is located on the north end of the Sechelt Peninsula in south-western British Columbia, within 150 km of Vancouver.

The property lies west of the town of Egmont, BC and covers most of North Lake and the ground to the north end of the peninsula, an area of 1060.17 hectares comprised of eighteen (18) contiguous mineral claims registered in the Vancouver Mining Division. The Earl's Cove to Egmont secondary paved road crosses the property.

Name	Tenure #	Area (ha)	Date Located	Good to Date	Owner
Gypsy Dancer	1081663	208.76	March 15, 2021	March 15, 2022	J. P. Larue
Dancer 2	411733	25.00	June 26, 2004	December 31, 2030	J. P. Larue
Sundancer	849232	83.50	March 17, 2011	December 31, 2030	J. P. Larue
Dancer 1	411732	25.00	June 26, 2004	December 31, 2030	J. P. Larue
Dancer 3	411734	25.00	June 26, 2004	December 31, 2030	J. P. Larue
Dancer 4	411735	25.00	June 26, 2004	December 31, 2030	J. P. Larue
Rhianna Dancer	562233	83.49	July 7, 2007	December 31, 2030	J. P. Larue
Sundancer	718402	104.37	March 8, 2010	December 31, 2030	J. P. Larue
Dancer	849231	41.75	March 17, 2011	December 31, 2030	J. P. Larue
Sundancer	849232	83.50	March 17, 2011	December 31, 2030	J. P. Larue
Spirit dancer	1032627	62.61	December 8, 2014	December 31, 2030	J. P. Larue
Chalice East	1066947	83.48	March 3, 2019	June 8, 2024	J. Bakus
Aurum Dancer 2	1080152	41.74	December 21, 2020	December 21, 2021	J. P. Larue
Aurum Dancer	1077340	20.87	July 18, 2020	July 18, 2021	J. P. Larue
Aurum Dancer 3	1080153	20.87	December 21, 2020	December 21, 2021	J. P. Larue
	1058985	83.49	March 2, 2018	June 8, 2024	J. Bakus
Chalice SW 2	1070669	20.87	August 28, 2019	June 1, 2021	J. Bakus
Chalice SW	1066955	20.87	March 3, 2019	June 8, 2021	J. Bakus

1060.17 ha

Claim Tenures

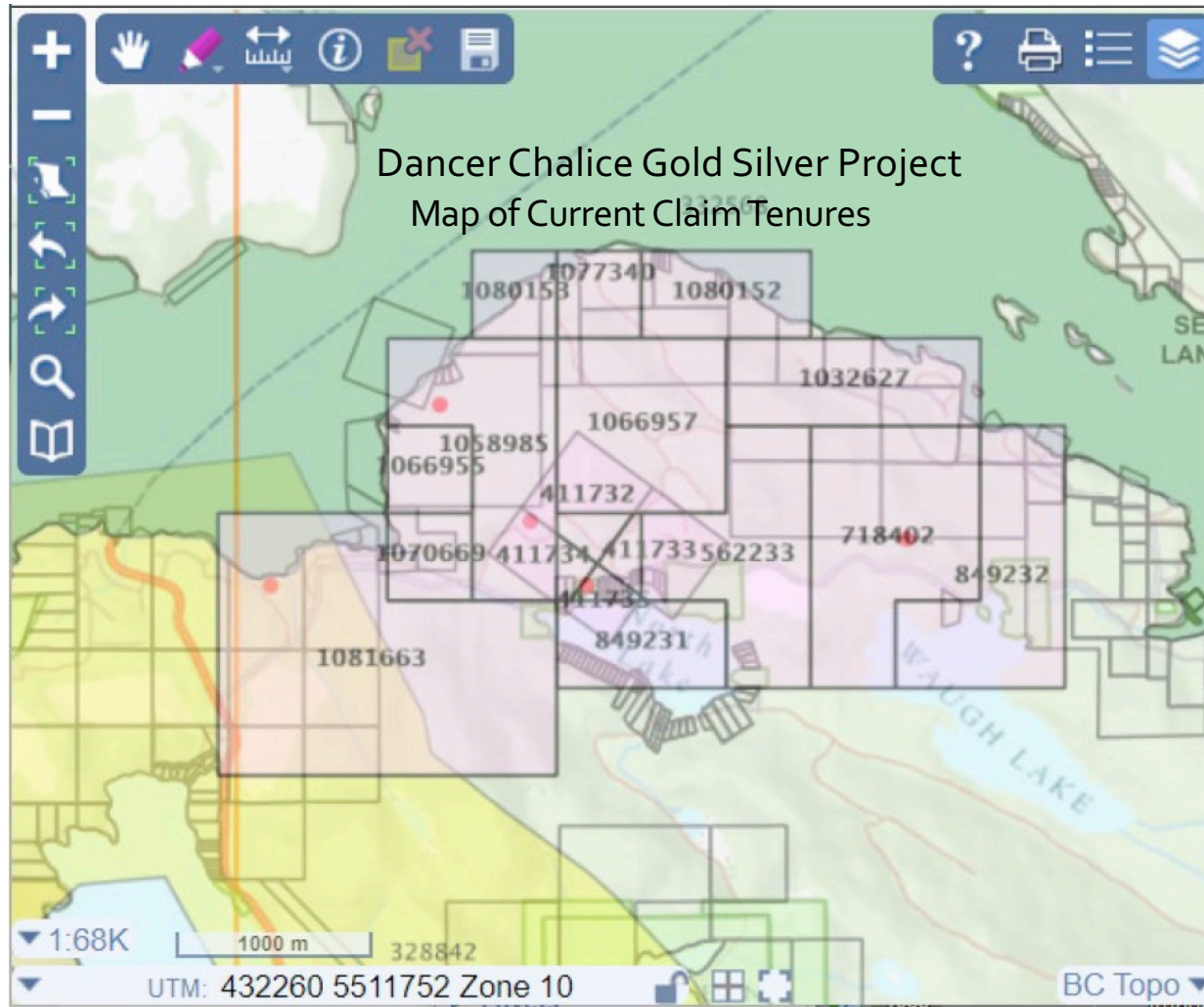

Prospector: John LaRue - AMA Gold Exploration Ltd.
Property Location: Egmont

Sponsored in part by:
 **FOUNDEX**
EXPLORATIONS LTD.

Regional Geology



- The region surrounding the property is mainly underlain by intrusive rocks of the Jurassic to Cretaceous Coast Plutonic Complex largely composed of quartz diorite, diorite, and granodiorite.
- Northwest trending roof pendants or septa of metamorphosed intermediate volcanic and sedimentary rocks of the Upper Triassic Karmutsen Group are also present.

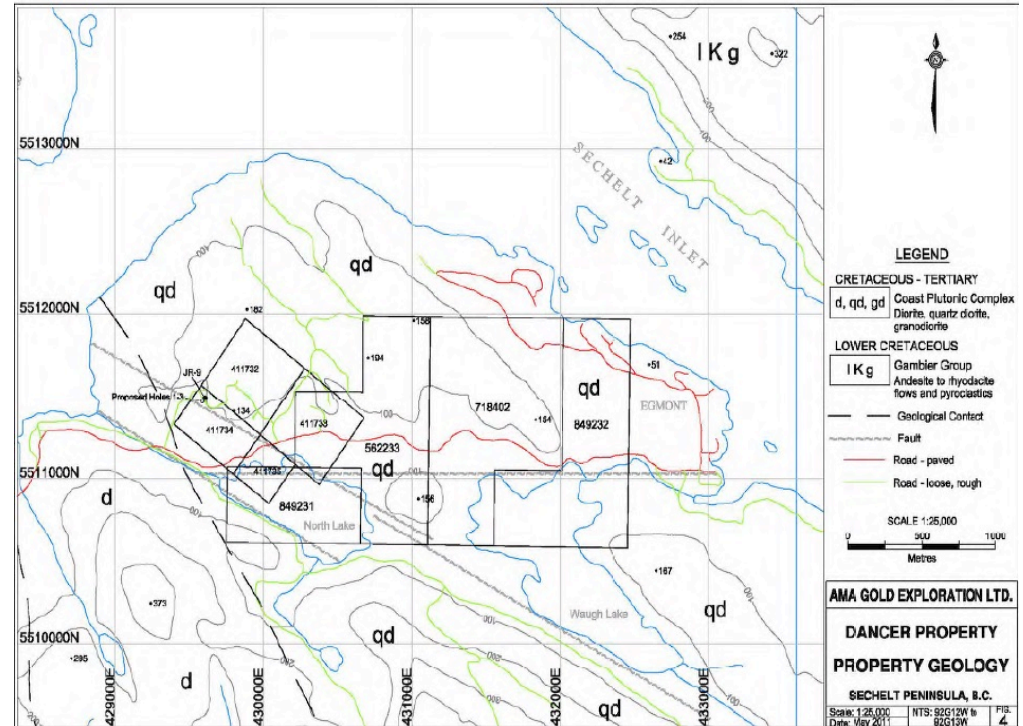

Local Geology



- Grove (1985) indicates thirty gold-bearing showings have been discovered on the Property. Grades tend to be rich with values up to 301 g/t Au (8.8 ounces per ton) and 363 g/t Ag (10.5 opt) from sulphide rich material. The best drill intercept was on the JR Zone: 31.3 g/t Au/2.1 metres (0.90 oz/t Au/9'). DDH-JR-9 intersected 2.74 metres of quartz-marcasite vein with visible electrum assaying 28.02 g/t gold and 19.4 g/t silver.
- Gold occurs in a number of settings: a) in massive sulphide veins; b) sulphide bearing quartz veins; c) quartz vein stockwork zones; d) mineralized breccia zones, and; e) disseminated breccia zones.
- Pyrite and particularly marcasite are the dominant sulphide minerals. The mineralogy together with the drusy nature of the quartz and the fracture-filling nature of the sulphides suggest “that the gold mineralization represents a widespread, high level, epithermal (low temperature) volcanically related type of mineralization.
- Gold mineralization on the property is hosted by sub-parallel quartz veins containing Pyrite/Marcasite in granodiorite often near feldspar porphyry dikes. On surface the mineralized veins appear to have continuity and are not pods or “blow-outs”. As continuity is established, then Bulk Sampling can proceed.

History of Project

Historic Exploration

- 50 km grid, mapping, & gold soil geochemistry
- 40 km Proton Mag, VLF-EM
- 11 km Multi Level Induced Polarization
- Trenching
- 572 metres of diamond drilling in 21 short holes
- Best drill intercept JR Zone 0.902 oz Au/ton + 0.604 oz Ag/ton over 9' true width

2015 through Present

- Relocation / Validation of Historic Discoveries & Grades
- Indigenous Consultation – Archaeological Impact Assessment
- Metallurgical Studies
- Mining Permit MX-7-283 for 1000 metres of diamond drilling and a 10,000 tonne Bulk Sample from JR Zone good through 2022
- 4 km of Self Potential Survey
- Excavation and re-discovery of JR Zone Showing & test drilling of Ribbon Marker showing collar location
- Synthetic Aperture Radar (SAR) Satellite Imagery Conductivity Estimate Study



Correlative Geophysical Anomalies and Showings



Prospector: John LaRue - AMA Gold Exploration Ltd.
 Property Location: Egmont

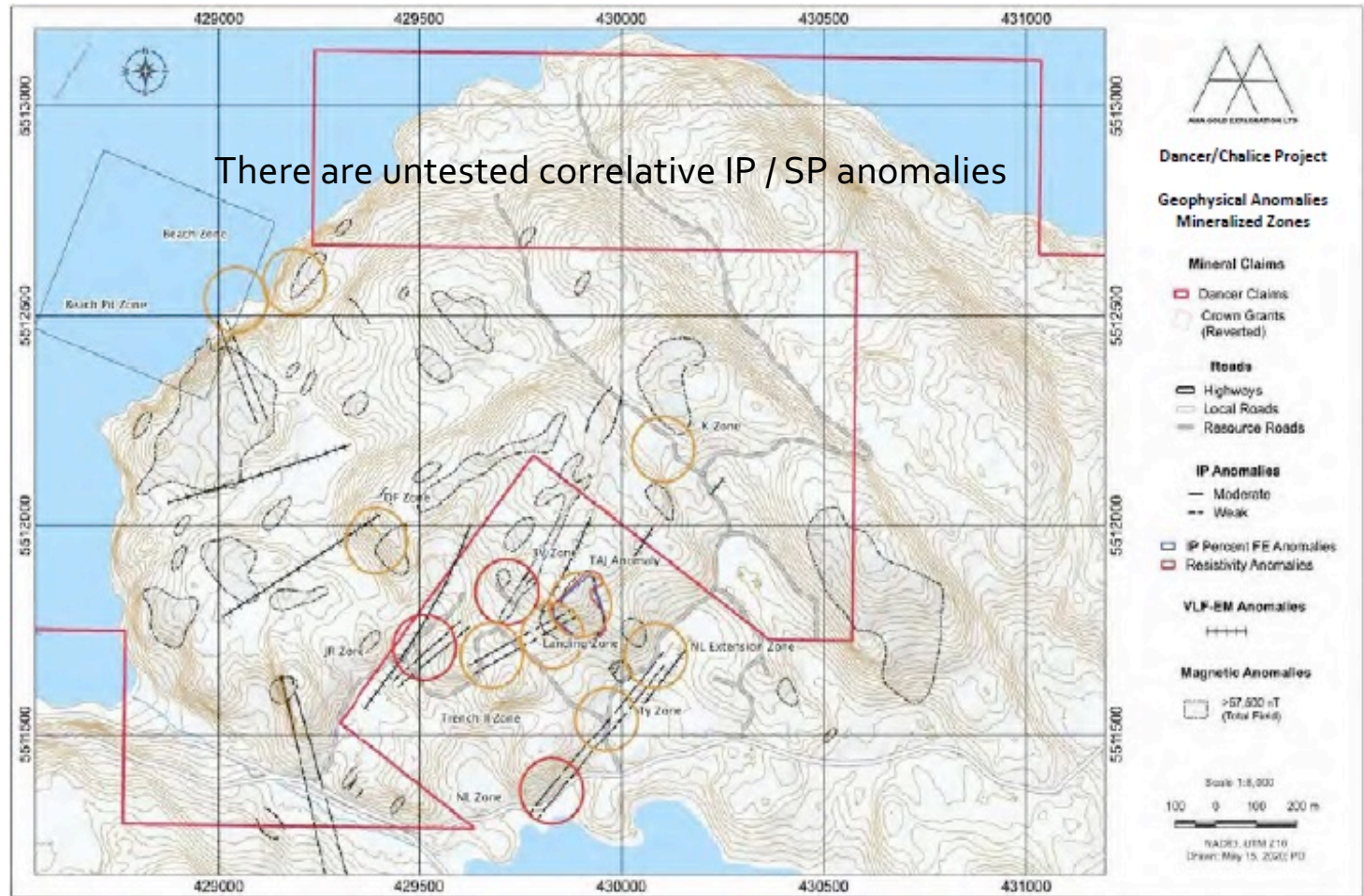

Sponsored in part by:
FOUNDEX
 EXPLORATIONS LTD.

Significant Historic Drill Core Intercepts



Significant Historic Diamond Drill Core Intercepts – Chalice Mining Inc. 1985

Ddh	Collar Location (Property Grid)	Az	Inc	Interval (m)	Core Length	g/t gold	g/t silver
NL-3	450E 300N	157°	-55°	9.5-10.7	1.2m	13.8	22.2
NL-10	475E 300N	320°	-25°	2.1-3.0	0.9m	18.1	24.3
NL-12	475E 300N	320°	-45°	2.7-3.4	0.7m	10.3	3.1
JR-9	005W 395N	035°	-45°	8.2-10.9	2.7m	28.02	19.4
DF-2	282W 500N	155°	-80°	3.0-3.4	0.4m	3.2	4.2
TY-11	425E 575N	045°	-87°	1.8-3.7	1.9m	1.9	0.2
Wally-15	L0 105W	040°	-65°	8.2-10.2	2.0m	0.21	10.5
Wally-16	26W 15S	030°	-45°	12.2-17.7	5.5m	0.22	0.6
Wally 17	26W 45S	030°	-45°	33.5-35.1	1.6m	1.0	0.3

JR Zone Self- Potential Survey



Two SP surveys in April and September 2019 on the “JR Showing” have been plotted in a compilation with drilling and rock geochemistry data. A high electric potential difference has been noted in three zones.

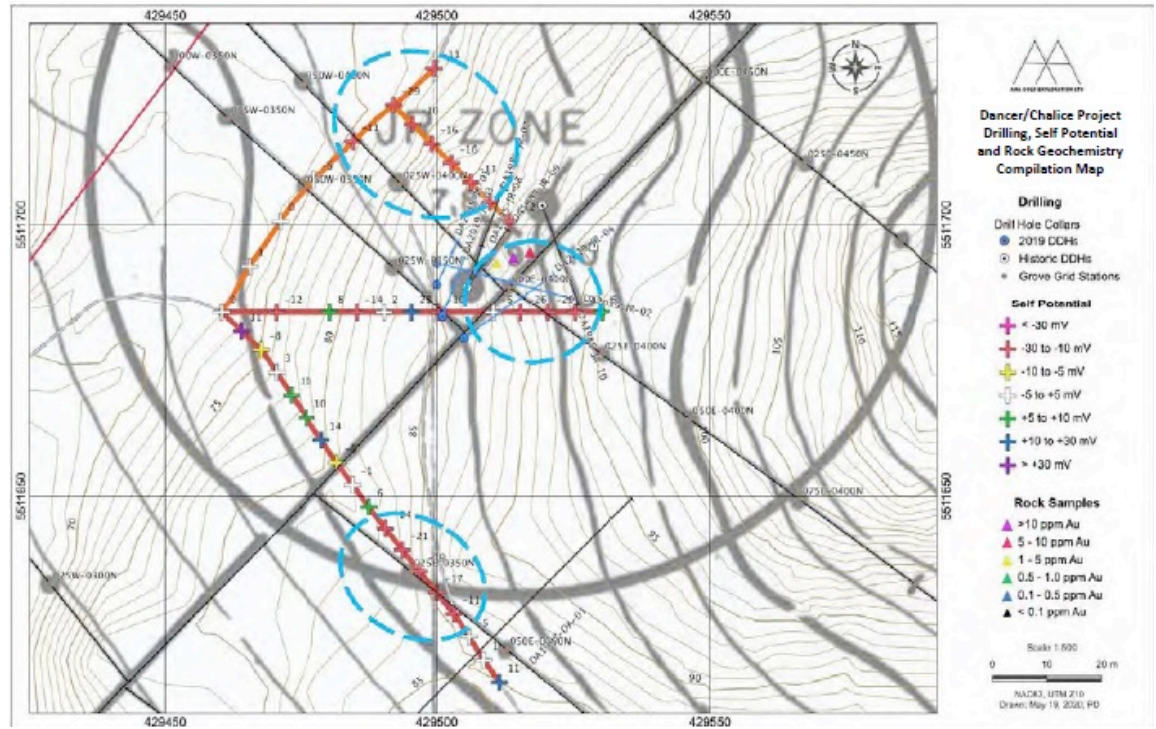

Prospector: John LaRue - AMA Gold Exploration Ltd.
Property Location: Egmont

Sponsored in part by:

FOUNDEX
EXPLORATIONS LTD.

SAR (satellite imagery) Conductivity Estimate



SAR (Synthetic Aperture Radar Satellite Imagery) estimated conductivity in core zones (using Pendock 2019 DC Estimates) demonstrating correlation with known mineralized zones and showings

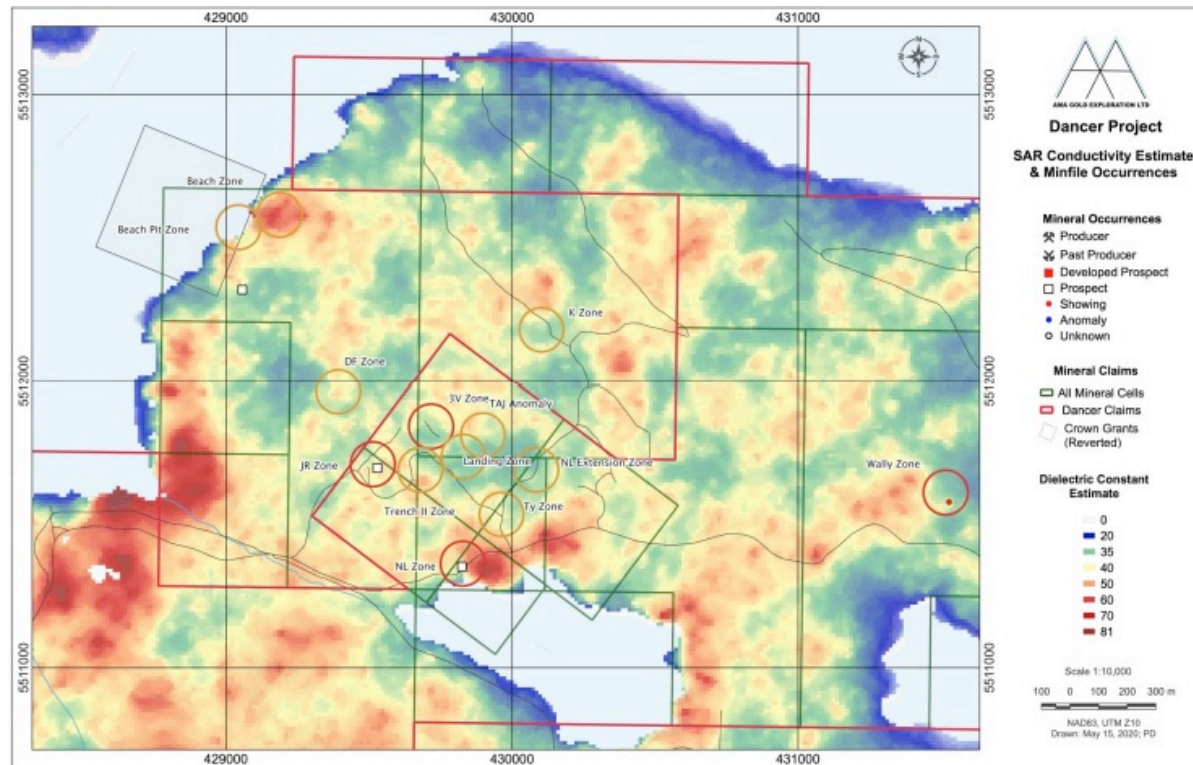

Prospector: John LaRue - AMA Gold Exploration Ltd.
Property Location: Egmont

Sponsored in part by:
FOUNDEX
EXPLORATIONS LTD.

Key Highlights



- 5 Year Mining Permit and Bonding in place to conduct 1000 metres of diamond drilling and extract a 10,000 tonne Bulk Sample from the JR Zone. Permit extends through October 2022
- More than 30 significant surface Gold-Silver showings have been identified and more than 3 km of correlative geophysical / geochemical anomalies delineated
- Consultation since 2008 with *shishalh* Indian Band on development plans. In 2017-2018 we jointly completed an Archaeological Impact Study over the 4 legacy Dancer Claims. No items of cultural significance were found in the study
- Metallurgical Testing of the NL Vein material in 2017 produced a coarse single pass flotation concentrate recovering more than 97% of the gold and 99% of the silver to a product grading 109 g/tonne gold (3.18 oz ton) and 46 g/tonne silver (1.24 oz/ton), that was relatively void in elements that typically result in smelting penalties
- Significant IP/SP, geochemical, and SAR Conductivity Estimate anomalies have been identified that remain unexplored and untested
- Temperate climate so property can be developed year round with local highway and forest road infrastructure providing good access
- Potential to develop a cash flow from our permitted exploration plans
- Comprehensive Technical Report written by P. Despotovic, MSc Geo., GIT (June 21, <https://1drv.ms/u/s!Av5SNQS642AZiEeLMJ9jPzVzwXDO?e=4JrV7Z>)
- New Technical Report on the Dancer Chalice Project has been written by J. Shearer, M.Sc., P.Geo. (April 30th, 2021) to comply with NI 43-101 standards recommending phased expenditures of \$820,000 in development work

THANK YOU

Prospector John La Rue
Dancer Chalice Gold-Silver Project
Ama Gold Exploration Ltd.
Box 1044 Lillooet, BC V0K 1V0
250.256.1840
amagoldexploration@gmail.com

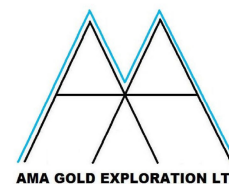

Thank you to our session
sponsor:



FOUNDEX
EXPLORATIONS LTD.